

Walnut combines thoughtful modern design with old-world craft.

🌐 walnutstudiolo.com
📞 503.447.6889

“The Fremont” Leather Drawer Pull Installation Instructions

- First, you'll need to drill a hole using a 7/32" drill bit. I recommend marking the hole first with a smaller pilot hole using an 1/8" drill bit.
- Take a look at your hardware. The hardware provided includes two screws, choose the one that fits yours best. The screws are 3/8" and 3/4" long. The shorter 3/8" screw should work great for all single unfaced cabinetry (like IKEA's). The longer 3/4" screw allows the handle to be installed on custom drawers that have two layers of material, a box with a face on it. The washer provides additional support but can be eliminated if you choose.
- Take the leather strap, fold it in a circle with the finished side facing you, lining up the holes so that the finished side of one end is touching the rough backside of the other end to form the handle. If you're installing multiple handles, be sure to fold over the same ends on each handle so that they match (right-to-left or left-to-right...or not, if you prefer that look!).
- Thread the Chicago screw (surfaceless head) through the (optional) washer and the leather straps, and into the hole you drilled in the cabinet.
- Secure from the backside with the included screw of the length that will fit your cabinet. Nicely done!

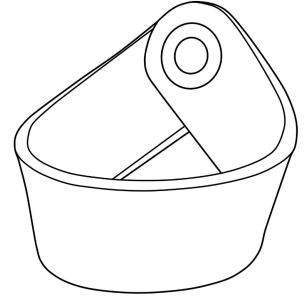

We'd love to see pictures of your installations! Share them with us at walnutstudiolo@gmail.com, or find us on social media as [@walnutstudiolo](https://www.instagram.com/walnutstudiolo)

What to do with that extra hardware?

We include duplicate hardware with your handle for max flexibility. Instead of throwing away, you could:
a) keep it for future use, in case you want to move the handles, b) recycle it with mixed metals, or
c) mail it back to us for re-use: Walnut Studiolo - Reuse Program, 36005 Hwy 53, Nehalem OR 97131.



walnut



Walnut combines thoughtful modern design with old-world craft.

🌐 walnutstudiolo.com
📞 503.447.6889

“The Fremont” Leather Drawer Pull Installation Instructions

- First, you'll need to drill a hole using a 7/32" drill bit. I recommend marking the hole first with a smaller pilot hole using an 1/8" drill bit.
- Take a look at your hardware. The hardware provided includes two screws, choose the one that fits yours best. The screws are 3/8" and 3/4" long. The shorter 3/8" screw should work great for all single unfaced cabinetry (like IKEA's). The longer 3/4" screw allows the handle to be installed on custom drawers that have two layers of material, a box with a face on it. The washer provides additional support but can be eliminated if you choose.
- Take the leather strap, fold it in a circle with the finished side facing you, lining up the holes so that the finished side of one end is touching the rough backside of the other end to form the handle. If you're installing multiple handles, be sure to fold over the same ends on each handle so that they match (right-to-left or left-to-right...or not, if you prefer that look!).
- Thread the Chicago screw (surfaceless head) through the (optional) washer and the leather straps, and into the hole you drilled in the cabinet.
- Secure from the backside with the included screw of the length that will fit your cabinet. Nicely done!

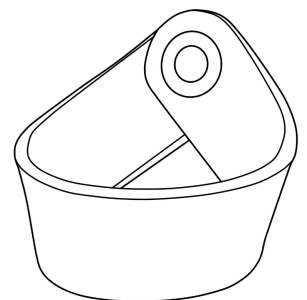

We'd love to see pictures of your installations! Share them with us at walnutstudiolo@gmail.com, or find us on social media as [@walnutstudiolo](https://www.instagram.com/walnutstudiolo)

What to do with that extra hardware?

We include duplicate hardware with your handle for max flexibility. Instead of throwing away, you could:
a) keep it for future use, in case you want to move the handles, b) recycle it with mixed metals, or
c) mail it back to us for re-use: Walnut Studiolo - Reuse Program, 36005 Hwy 53, Nehalem OR 97131.



walnut



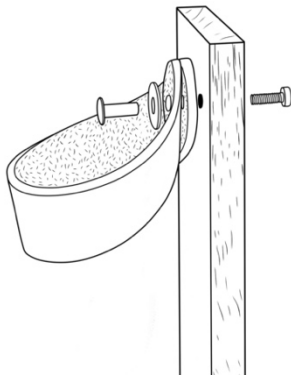
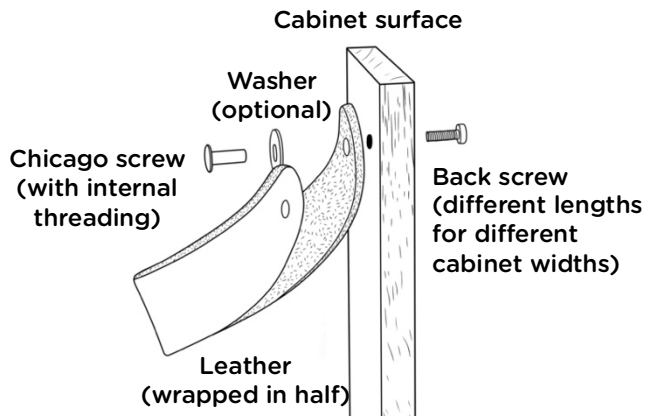

OPTIONAL "FLAT" INSTALLATION:
The Fremont can be installed "flat" with 2 points of contact, using an extra hardware kit (sold separately).

Here is our guidance for approximate center-to-center (C2C) dimensions (how far apart to drill the holes):

Size	Recommended C2C Spacing
Small	4.5" (11.4cm) +/- 0.25" (0.6cm)
Large	9" (22.9cm), +/- 0.25" (0.6cm)
Wide	9" (22.9cm), +/- 0.25" (0.6cm)

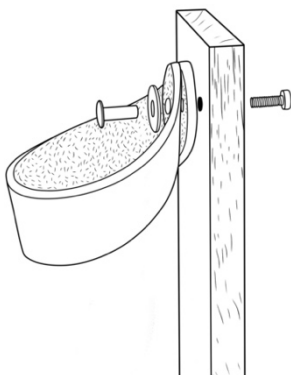
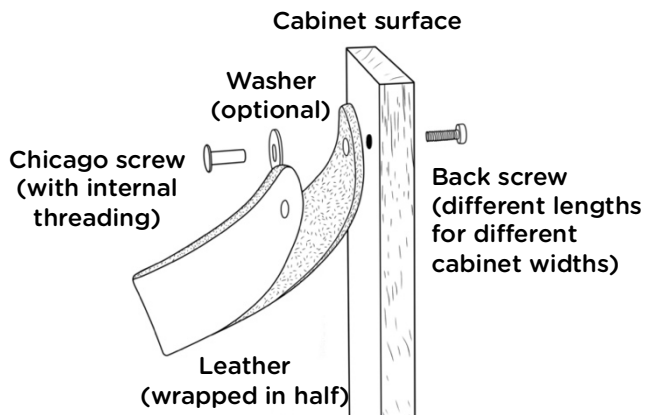

OPTIONAL "FLAT" INSTALLATION:
The Fremont can be installed "flat" with 2 points of contact, using an extra hardware kit (sold separately).

Here is our guidance for approximate center-to-center (C2C) dimensions (how far apart to drill the holes):

Size	Recommended C2C Spacing
Small	4.5" (11.4cm) +/- 0.25" (0.6cm)
Large	9" (22.9cm), +/- 0.25" (0.6cm)
Wide	9" (22.9cm), +/- 0.25" (0.6cm)